

THE FOREST LIGHT

is simulating the experience of walking beneath the trees while walking in the forest when the direct sun rays shuttered and create special forms on surfaces or reflected by different objects.

The pavilion is made of module of steel cube covered by wood and connected

with simple screws coming through slots which makes it easy to build and dissemble.

Every cube has two LEDs strips that make an alternative show at night, the LEDs is connected by cables inside the wooden cover and reach the ground.

The shape of the pavilion – half a circle is defined by the

road that surround it and create a small amphi theater that can serve the back side of the Glyptothek Museum.

The location of the pavilion is close to the Menza and the TUM which make it a good place to meet and use by the students.

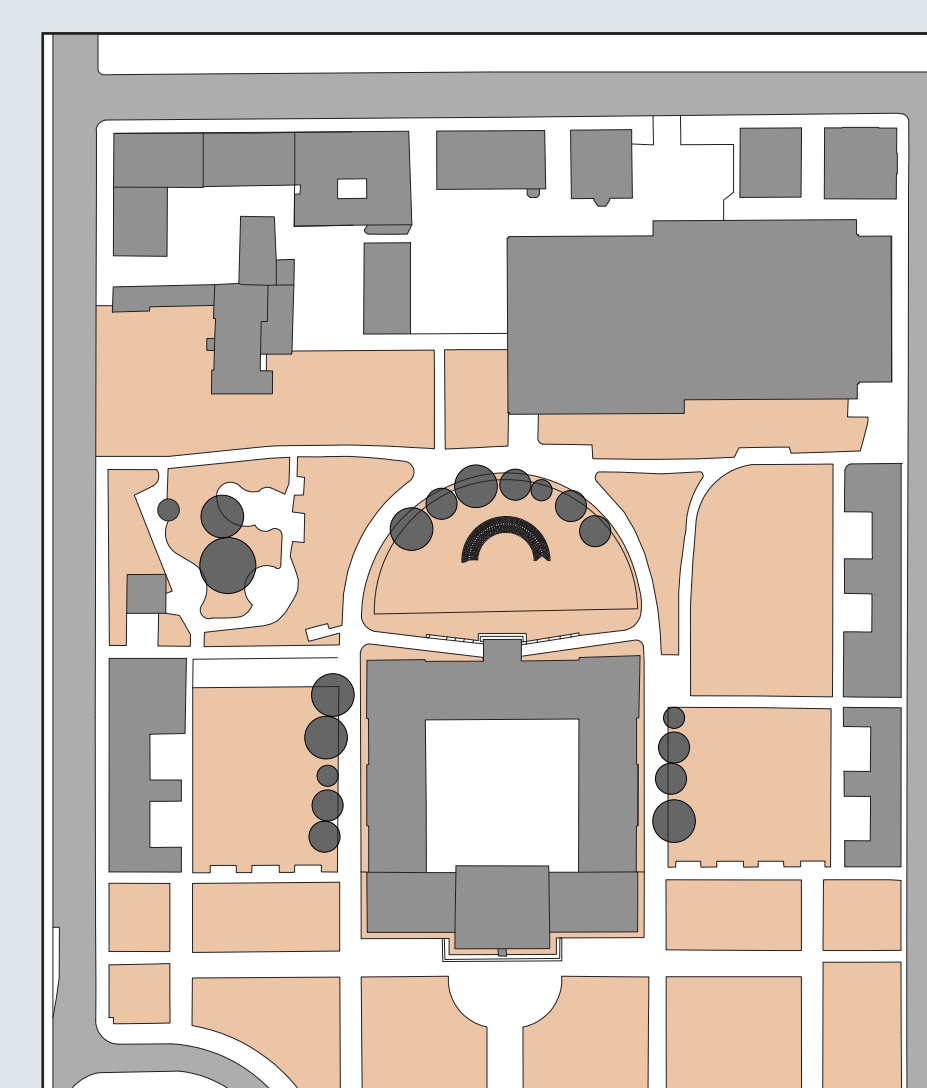

•
•
•